

KEY		Distance	
Route 1	Shafesbury Avenue - Wardour Street - Broadwick Street - Poland Street - Great Marlborough Street - Regent Street	km	miles
		1.01	0.63

FOR VEHICLE MOVEMENTS
REFER TO DRAWING:
VSP-MG-COW-BROADWICK
STREET-006

FOR VEHICLE MOVEMENTS
REFER TO DRAWING:
VSP-MG-COW-BROADWICK
STREET-002

FOR VEHICLE MOVEMENTS
REFER TO DRAWINGS:
VSP-MG-COW-BROADWICK
STREET-003, 004 AND 005

PARKING TO
BE SUSPENDED.

PARKING TO
BE SUSPENDED.

PARKING TO
BE SUSPENDED.
DISABLED SPACE
TO BE RELOCATED.

SITE LOCATION

FOR VEHICLE MOVEMENTS
REFER TO DRAWING:
VSP-MG-COW-BROADWICK
STREET-001

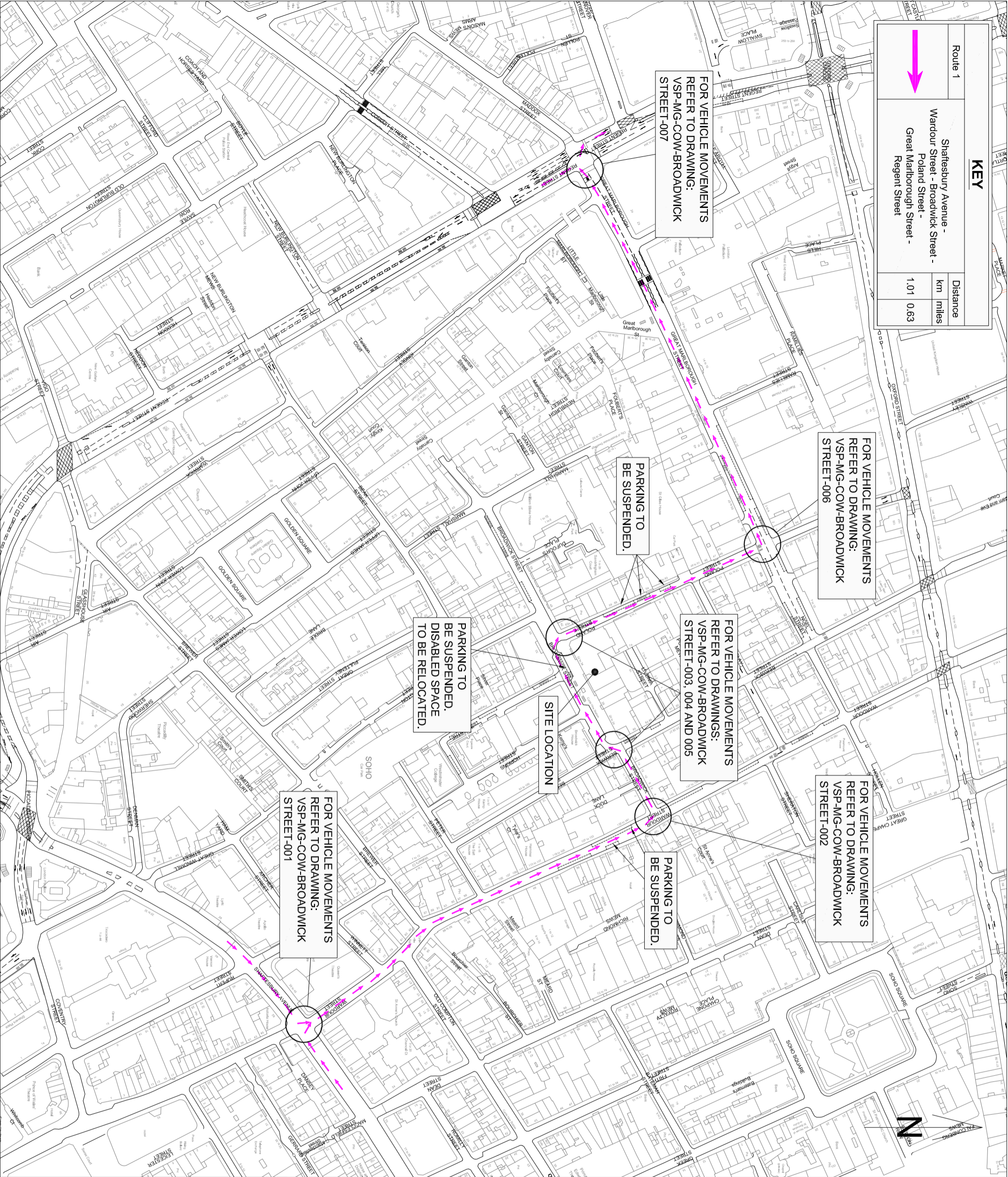

DO NOT SCALE FROM THIS DRAWING.
All dimensions to be verified on site.

This drawing has been produced for the specific client and project identified below and is not intended for use by any other person or for any other purpose.
© Traffic Management Technical Services Ltd

NOTES

1. All signs as per Chapter 8. Distances between cones to be 3m maximum unless otherwise noted.
2. All tapers to cones to be as per Chapter 8. Works are not permitted to be carried out within the taper.
3. Minimum no. hazard lamps: 9 per 6m hazard width.
4. Distances between signs NOT to scale for purposes of clarity.
5. All sign placement subject to available safe working space.

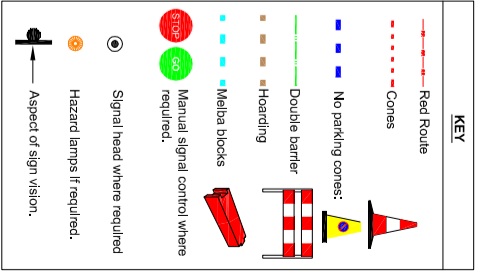

www.drawingahead.com

Telephone: 020 8667 9687 Web: www.drawingahead.com

scale at A3	date	drawn	chk1	chk2
1:2500	27.02.14	RGS	RGS	-

Client

MadiganGill

Project
CITY OF WESTMINSTER
BROADWICK STREET

VEHICLE ROUTE TO AND FROM SITE
SHEET 1

DWG REF:
TM-MG-COW-BROADWICK STREET-001

REV:

00